



HID-Basic ballasts for HPL and HPI(PLUS) lamps

BHL E 400 L202

The HID-Basic ballast is an impregnated (HID standard) electromagnetic ballast for HID lamps, for use in combination with an external ignitor.

Product data

General Information		Temperature	
Application code	L202	T-winding (max.)	130 °C
		Delta-T normal conditions	70/75 °C
Operating and Electrical		Approval and Application	
Input Voltage	230 V	Approval marks	CE marking
Input frequency	50 Hz		
Power factor 100% load (min.)	0.85	Product Data	
Mains voltage performance (AC)	-8%+6%	Full product code	872790084180000
Mains voltage safety (AC)	-10%+10%	Order product name	BHLE 400L 202
Input current with PF correction	2.15 A	EAN/UPC – product	8711500997913
Input current without PF Correction	3.25/3.4 A	Order code	84180000
Power factor without PF compensation (nom.)	0.60	Numerator – quantity per pack	1
Power losses (nom.)	27.5/30.5 W	SAP numerator – packs per outer box	6
Wiring		Material no. (12 NC)	913713017650
Connector type	Screw	Net Weight (Piece)	3.140 kg
System characteristics			
Rated ballast-lamp power	400 W		

HID-Basic ballasts for HPL and HPI(PLUS) lamps

Dimensional drawing

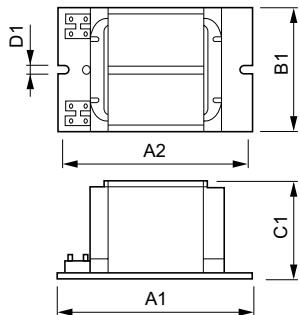

Product	D1	C1	A1	A2	B1
BHLE 400L 202	6.2 mm	64.5 mm	165.0 mm	144.0 mm	75.5 mm

BHLE 400 L202

