



Quebec LED

BRP776 LED16-4S/740 PSD DW50 PGR BK D9 S

QUEBEC LED - LED module 1600 lm - 4th generation, screw fixation - 740 neutral white - Power supply unit with DALI interface - Safety class I (I) - Distribution wide 50 - Flat glass - Black - Dimming via external communication DALI - Philips standard surge protection level kV - - - 25 °C - - - Side arm lateral

Quebec LED is a stylish luminaire designed to brighten up residential streets and pathways, precincts, parks and other urban spaces. It incorporates an energy-efficient LED engine with high-performance optics, while at the same time retaining the character of the original Quebec fixture. It also offers a choice of bowl versions and mounting options. All these factors together make Quebec LED a versatile solution that can meet the needs of any project.

Product data

General Information		Connection	Plug-in connector 3-pole Wieland/Adels compatible and 2x 2-pole control signal for light regulation
Lamp family code	LED16 [LED module 1600 lm]	Cable	-
Lamp version	4S [4th generation, screw fixation]	Protection class IEC	Safety class I (I)
Light source colour	740 neutral white	Flammability mark	NO [-]
Light source replaceable	Yes	CE mark	CE mark
Number of gear units	1 unit	ENEC mark	ENEC mark
Driver/power unit/transformer	PSD [Power supply unit with DALI interface]	Warranty period	5 years
Driver included	Yes	Optic type outdoor	Distribution wide 50
Optical cover/lens type	FG [Flat glass]	Remarks	*- According to the Lighting Europe guidance paper 'Evaluating performance of LED based
Luminaire light beam spread	23° - 8° x 152°		
Control interface	DALI		
Light regulation	Dimming via external communication DALI		

Quebec LED

	luminaires – January 2018': statistically there is no relevant difference in lumen maintenance between the B50 and, for example, the B10. Therefore, the median useful life (B50) value also represents the B10 value. * At extreme ambient temperatures the luminaire might automatically dim down to protect components
Constant light output	No
Number of products on MCB (16 A type B)	29
EU RoHS compliant	Yes
Light source engine type	LED
Serviceability class	Class A, the luminaire is equipped with serviceable parts (when applicable): LED board, driver, control units, surge-protection device, optics, front cover and mechanical parts
Product family code	BRP776 [QUEBEC LED]

Light Technical

Upward light output ratio	0.03
Standard tilt angle post-top	-
Standard tilt angle side entry	0°

Operating and Electrical

Input Voltage	220 to 240 V
Input frequency	50 to 60 Hz
Inrush current	15 A
Inrush time	0.295 ms
Power factor (min.)	0.97
Power factor (nom.)	0.92

Controls and Dimming

Dimmable	Yes
----------	-----

Mechanical and Housing

Housing material	Aluminum
Reflector material	-
Optic material	Polymethyl methacrylate
Optical cover/lens material	Glass
Fixation material	Aluminium
Mounting device	No [-]
Optical cover/lens shape	Flat
Optical cover/lens finish	Silkscreen print gray
Fixation type	Side arm lateral
Overall height	388 mm

Overall diameter	472 mm
Effective projected area	0.094 m ²
Colour	Black
Dimensions (height x width x depth)	388 x NaN x NaN mm (15.3 x NaN x NaN in)

Approval and Application

Ingress protection code	IP65 [Dust penetration-protected, jet-proof]
Mech. impact protection code	IK08 [5 J vandal-protected]
Surge protection (common/differential)	Philips standard surge protection level kV

Initial Performance (IEC Compliant)

Initial luminous flux	1328 lm
Luminous flux tolerance	+/-7%
Initial LED luminaire efficacy	128 lm/W
Init. Corr. Colour Temperature	4000 K
Init. Colour rendering index	>70
Initial chromaticity	(0.381, 0.379) SDCM <5
Initial input power	10.4 W
Power consumption tolerance	+/-11%

Over Time Performance (IEC Compliant)

Control gear failure rate at median useful life 100,000 h	10 %
Lumen maintenance at median useful life* 100,000 h	L98

Application Conditions

Ambient temperature range	-40 to +50 °C
Performance ambient temperature Tq	25 °C
Maximum dimming level	25%

Product Data

Full product code	871869908992400
Order product name	BRP776 LED16-4S/740 PSD DW50 PGR BK D9 S
EAN/UPC – product	8718699089924
Order code	08992400
Numerator – quantity per pack	1
Numerator – packs per outer box	1
SAP material	912300023482
SAP net weight (piece)	7.030 kg



Quebec LED

Dimensional drawing

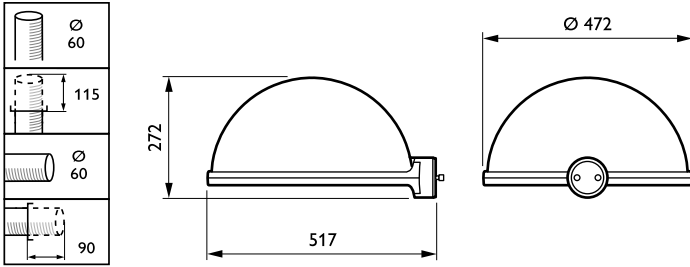

Quebec LED BRP775/776

Photometric data

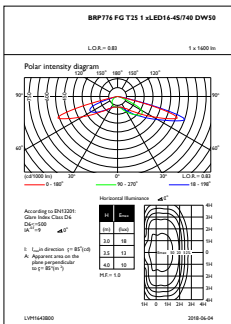

OFPL1_BRP776FGT251xLED16-4S740DW50

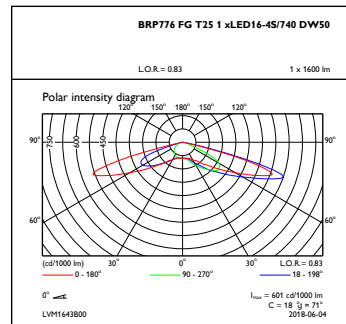

OFPC1_BRP776FGT251xLED16-4S740DW50

