



Spreadhead spiral shape energy saving products, preferred by over 90% of consumers

Tornado T2

Tornado has outstanding brightness which makes your colors appear more Vivid. It fits everywhere due to its compact design. With comprehensive product range, it allows easy replacement of incandescent lamps all the way.

Benefits

- Outstanding brightness & Vivid Colors
- Flicker-Free start & Fast run up
- Save your money with long life-time and high energy efficiency compare to incandescent lamp

Features

- Long-Life and Energy saving alternative to Incandescent lamps
- Fast Run-up
- Recommended ambient temperature range to ensure almost constant light output (>90%): 0 and + 50°C

Tornado T2

Application

- Replacement of incandescent lamps both in professional and home applications (hotels, restaurants, shops) where the lamp is not directly visible; especially suitable for use in indoor functional areas
- Enclosed fixtures required for outdoor applications
- Not suitable for use with dimmers or electronic gear

Warnings and Safety

- Breaking a lamp is extremely unlikely to have any impact on your health. If a lamp breaks, ventilate the room for 30 minutes and remove the parts, preferably with gloves. Put them in a closed plastic bag and take it to your local waste facilities for recycling. Do not use a vacuum cleaner.
- Compact fluorescent lamps have to be treated as special waste, they must be taken to your local waste facilities for recycling. The European Lighting Industry has set up an infrastructure, capable of recycling mercury, other metals, glass etc.

Versions



Dimensional drawing

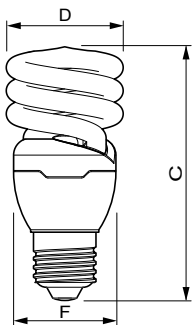

Product	D (max)	C (max)	F (max)
TornadoT2 8y 15W CDL E27 220-240V 1CT/12	51.5 mm	107.5 mm	42.5 mm

Tornado T2

Dimensional drawing

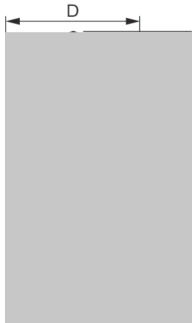

Product	D (max)	C (max)	F (max)
Tornado T2 8y 20W WW E27 220-240V 1CT/12	56.5 mm	111.5 mm	47 mm

Product	D (max)	C (max)	F (max)
Tornado T2 8y 23W WW E27 220-240V 1CT/12	61.5 mm	118.5 mm	50.5 mm
TornadoT2 8y 23W CDL E27 220-240V 1CT/12	61.5 mm	118.5 mm	50.5 mm

Approval and Application

Energy Efficiency Label (EEL)	A
-------------------------------	---

Controls and Dimming

Dimmable	No
----------	----

Operating and Electrical

Input Frequency	50 or 60 Hz
Voltage (Nom)	220-240 V
Starting Time (Nom)	0.3 s
Warm Up Time To 60% Light (Max)	60 s
Warm Up Time To 60% Light (Min)	5 s

General Information

Cap-Base	E27
Nominal Lifetime (Nom)	8000 h
Rated Lifetime (Hours)	8000 h
Switching Cycle	5,000X

Light Technical

Llmf At End Of Nominal Lifetime (Nom)	70 %
Lumen Maintenance 2000 h (Nom)	85 %
Lumen Maintenance 5000 h (Nom)	75 %

Mechanical and Housing

Bulb Shape	Spiral
------------	--------

Approval and Application

Order Code	Full Product Name	Energy Consumption kWh/ 1000 h	Mercury (Hg) Content (Nom)
66290700	TornadoT2 8y 15W CDL E27 220-240V 1CT/12	15 kWh	-
66296900	Tornado T2 8y 20W WW E27 220-240V 1CT/12	20 kWh	1.5 mg
66300300	Tornado T2 8y 23W WW E27 220-240V 1CT/12	23 kWh	2 mg
66298300	TornadoT2 8y 23W CDL E27 220-240V 1CT/12	23 kWh	2 mg

Tornado T2

Operating and Electrical

Order Code	Full Product Name	Lamp Current (Nom)	Power (Rated) (Nom)
66290700	TornadoT2 8y 15W CDL E27 220-240V 1CT/12	110 mA	15 W
66296900	Tornado T2 8y 20W WW E27 220-240V 1CT/12	150 mA	20 W

Order Code	Full Product Name	Lamp Current (Nom)	Power (Rated) (Nom)
66300300	Tornado T2 8y 23W WW E27 220-240V 1CT/12	170 mA	23 W
66298300	TornadoT2 8y 23W CDL E27 220-240V 1CT/12	170 mA	23 W

Light Technical (1/2)

Order Code	Full Product Name	Chromaticity		Colour	
		Coordinate X (Nom)	Coordinate Y (Nom)	Code	Designation
66290700	TornadoT2 8y 15W CDL E27 220-240V 1CT/12	313	337	865	Cool Daylight
66296900	Tornado T2 8y 20W WW E27 220-240V 1CT/12	463	420	827	Warm White (WW)

Order Code	Full Product Name	Chromaticity		Colour	
		Coordinate X (Nom)	Coordinate Y (Nom)	Code	Designation
66300300	Tornado T2 8y 23W WW E27 220-240V 1CT/12	463	420	827	Warm White (WW)
66298300	TornadoT2 8y 23W CDL E27 220-240V 1CT/12	313	337	865	Cool Daylight

Light Technical (2/2)

Order Code	Full Product Name	Correlated Colour Temperature (Nom)	Colour Rendering Index (Nom)	Luminous Efficacy (rated) (Nom)	Luminous Flux (Nom)	Luminous Flux (Rated) (Nom)
		66290700	TornadoT2 8y 15W CDL E27 220-240V 1CT/12	6500 K	80	61 lm/W
66296900	Tornado T2 8y 20W WW E27 220-240V 1CT/12	2700 K	82	65 lm/W	1250 lm	1250 lm
66300300	Tornado T2 8y 23W WW	2700 K	82	67 lm/W	1550 lm	1570 lm

Order Code	Full Product Name	Correlated Colour Temperature (Nom)	Colour Rendering Index (Nom)	Luminous Efficacy (rated) (Nom)	Luminous Flux (Nom)	Luminous Flux (Rated) (Nom)
		66298300	TornadoT2 8y 23W CDL E27 220-240V 1CT/12	6500 K	80	63 lm/W

