



HID-Basic ballasts for HPL and HPI(PLUS) lamps

BHL E 250 L202

The HID-Basic ballast is an impregnated (HID standard) electromagnetic ballast for HID lamps, for use in combination with an external ignitor.

Product data

General Information	
Application code	L202
Operating and Electrical	
Input Voltage	230 V
Input frequency	50 Hz
Power factor 100% load (min.)	0.85
Mains voltage performance (AC)	-8%~+6%
Mains voltage safety (AC)	-10%~+10%
Input current with PF correction	1.35 A
Input current without PF Correction	2.13/2.15 A
Power factor without PF compensation (nom.)	0.60
Power losses (nom.)	21.6 W
Wiring	
Connector type	Screw
System characteristics	
Rated ballast-lamp power	250 W

Temperature	
T-winding (max.)	130 °C
Delta-T normal conditions	70/75 °C
Approval and Application	
Approval marks	CE marking
Product Data	
Full product code	872790084179400
Order product name	BHLE 250L 202
EAN/UPC – product	8711500997906
Order code	84179400
SAP numerator – quantity per pack	1
Numerator – packs per outer box	6
SAP material	913713017550
SAP net weight (piece)	2.070 kg

HID-Basic ballasts for HPL and HPI(PLUS) lamps

Dimensional drawing

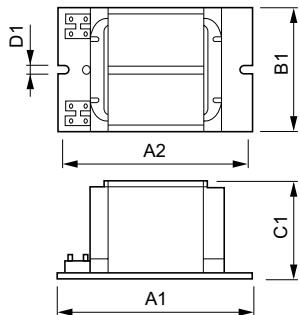

Product	D1	C1	A1	A2	B1
BHLE 250L 202	6.2 mm	64.5 mm	132.5 mm	119.0 mm	75.5 mm

BHL E 250 L202

