



# GreenSpace Flex

## RS378B P15 927 PSR-E WB M55

GreenSpace Flex, 15 W, 927 warm white, 40°, KNX, Finger-protected

GreenSpace Flex is performance portfolio dedicated to Hospitality segment for GC/GM countries. With modular design concept, the light engines and different trims could have multiply of combination to satisfy diversified customer's requirement.

### Product data

General Information	
Number of gear units	1 unit
Driver included	Yes
Light source engine type	LED
CE mark	-
Warranty period	3 years
Glow-wire test	Temperature 600 °C, duration 30 s
EU RoHS compliant	Yes

Light Technical	
Luminous Flux	1,140 lumen
Correlated Color Temperature (Nom)	2700 K
Luminous Efficacy (rated) (Nom)	76 lm/W
Color rendering index (CRI)	>90
Light source color	927 warm white
Optical cover/lens type	-
Luminaire light beam spread	40°

Operating and Electrical	
Input Voltage	220 to 240 V

Line Frequency	50 or 60 Hz
Average CLO power consumption	695 W
Power Consumption	15 W
Power Factor (Fraction)	0.9
Connection	External connector
Cable	-
Number of products on MCB of 16 A type B	-

Temperature	
Ambient temperature range	-20 to +45 °C

Controls and Dimming	
Dimmable	Yes
Driver/power unit/transformer	Electronic transformer
Control interface	KNX
Constant light output	No

Mechanical and Housing	
Housing Material	Aluminum Alloy
Optic material	Polymethyl methacrylate

## Greenspace Flex

Optical cover/lens material	-
Fixation material	Aluminum
Housing Color	Dark gray
Optical cover/lens finish	-
Overall length	0 mm
Overall width	0 mm
Overall height	72 mm
Overall diameter	55 mm
Dimensions (Height x Width x Depth)	72 x 0 x 0 mm

### Approval and Application

Ingress protection code	IP20 [Finger-protected]
Mech. impact protection code	IK04 [0.5 J standard plus]
Protection class IEC	Safety class II

### Initial Performance (IEC Compliant)

Luminous flux tolerance	+/-10%
Initial chromaticity	SDCM<3
Power consumption tolerance	+/-10%

### Over Time Performance (IEC Compliant)

Median useful life L80B50	50.000 hour(s)
---------------------------	----------------

### Application Conditions

Maximum dim level	10%
Suitable for random switching	No

### Product Data

Full product code	692382865070499
Order product name	RS378B P15 927 PSR-E WB M55
Order code	65070499
Numerator - Quantity Per Pack	1
Numerator - Packs per outer box	48
Material Nr. (12NC)	911401721402
Full product name	RS378B P15 927 PSR-E WB M55
EAN/UPC - Case	6923828653118
EAN/UPC - Product/Case	6923828650704

## Dimensional drawing

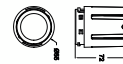
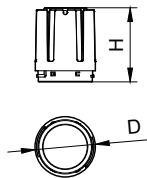

Modular Type	D, mm	H, mm
RS378B P6/P11 M55	55	49
RS378B P15 M55	55	49
RS378B P24 M70	70	90
RS378B P33 M87	87	107
RS378B P42 M102	102	116

